

MaxiDisc



Compact disc harrow

Mounted 3 and 4 m working width

Semi-mounted 4 – 5 and 6 m working width

Optimised soil cultivation

Typical to all sectors in agriculture, arable farmers need to adjust their costs to the income. One of the key words is to find machines with a suitable capacity, which are flexible and where the wearing costs are reasonable.

These objectives have been decisive in the development of

MaxiDisc:

- **Capacity** - high speed and wide working width
- **Flexibility** - cultivation of stubble and ploughed soil
- **Low wearing costs** - wear-resisting discs



The semi-mounted **MaxiDiscs** are fitted with hydraulic weight distribution by using the well known Dal-Bo DUOFLEX system. This incorporates a hydraulic accumulator which ensures even weight distribution across the working width of the machine.



The semi-mounted models are under 3 m wide when in the transport position.



The disc angle is **hydraulically** adjustable from 0 – 20°. It is possible while working to infinitely adjust the disc angle and working intensity in

relation to the changing soil and plant conditions.

MaxiDisc is just as effective in stubble fields as on ploughed land.

The angle relation between the first and second row is easily set by a spindle.



Hydraulic transport lock is fitted as standard.



MaxiDisc has a number of extras for example Bogie T-ring packer and seeder equipment.





In the rubber system the 560x6 mm discs are fitted on individual hubs. The pre-tensioned system ensures a uniform working depth in all conditions.

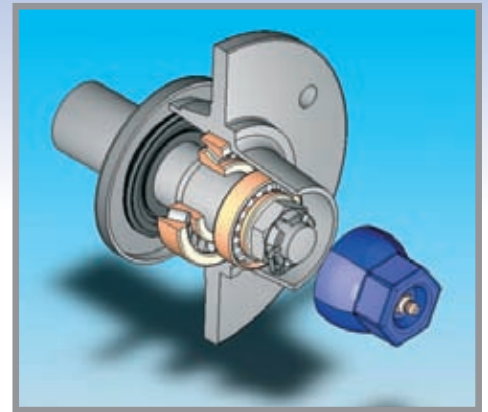

HD special hubs with double sealed conical roller bearings ensure a long life. The hubs must be greased every 50 hours.

The mounted **MaxiDisc** is fitted with a 600mm T-ring roller. The precise depth control is determined by the T-roller which also consolidates the soil. A good contact between soil and plant residues is the foundation for an efficient weed control. The roller is fitted with steel scrapers between each T-ring, which enables you to operate the machine in conditions that are not always ideal.



The semi-mounted **MaxiDiscs** are fitted with a HD 600 mm T-ring packer roller. The rings are made from 70x70x8 mm T-steel, facilitating a better carrying capacity and wear-ability. Furthermore the wider T-rings leave a finer soil structure.

The **MaxiDisc** is carried on the packer roller. A very precise depth control is achieved and the cultivated soil is consolidated perfectly. This speeds up the decomposition of plant residues and seeds.



At the front the depth is controlled by the tractor linkage arms and support wheels at the outside of the disc sections. The support wheels ensure a uniform working depth – also in changing soil conditions.



Optional equipment:



Flaps

To reduce the flow of plant residues and soil, it is recommended to fit a set of rubber flaps between first and second row of discs.



Bogie T-ring packer

Alternatively to the standard roller, the semi-mounted **MaxiDisc** can be equipped with a bogie-T-ring packer roller. This roller enhances machine stability and creates a finer structured seed bed.



El-hydr. control

Gives control over 4 DA functions via 1 DA outlet.



Extra support wheels

The semi-mounted **MaxiDisc** can be fitted with an additional set of support wheels. This makes it possible to maintain a very uniform working depth – also in hilly conditions.

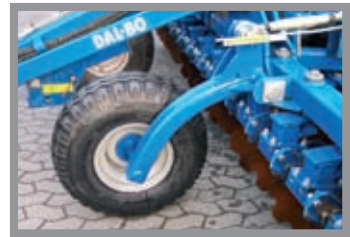

Wheel frame

The mounted **MaxiDisc** can be fitted with a transport kit.

Technical specifications:

Model	Working width	Number of discs	Weight Rubber	Transport width	Tractive force from
300 – mounted	3,00 m	24 pcs.	2.100 kg	3,00 m	100 hp
400 – mounted	4,00 m	32 pcs.	2.780 kg	4,00 m	120 hp
400 – semi-mounted	4,00 m	31 pcs.	5.010 kg	2,90 m	160 hp
500 – semi-mounted	5,00 m	39 pcs.	5.470 kg	2,90 m	180 hp
600 – semi-mounted	6,00 m	47 pcs.	5.950 kg	2,90 m	200 hp

Further stubble implements from DAL-BO.....

Tri-Max 3.0-4.1 m



AXR-H 4,00-6,00 m



Farmerdisc 3,00-4,00 m



DALBO – ROBUST AND RELIABLE